

- ### Convenções
- Piso tátil direcional
 - Rampas conforme detalhe
 - Passeio em PAVs
 - Saídas d'água
 - Meio fio

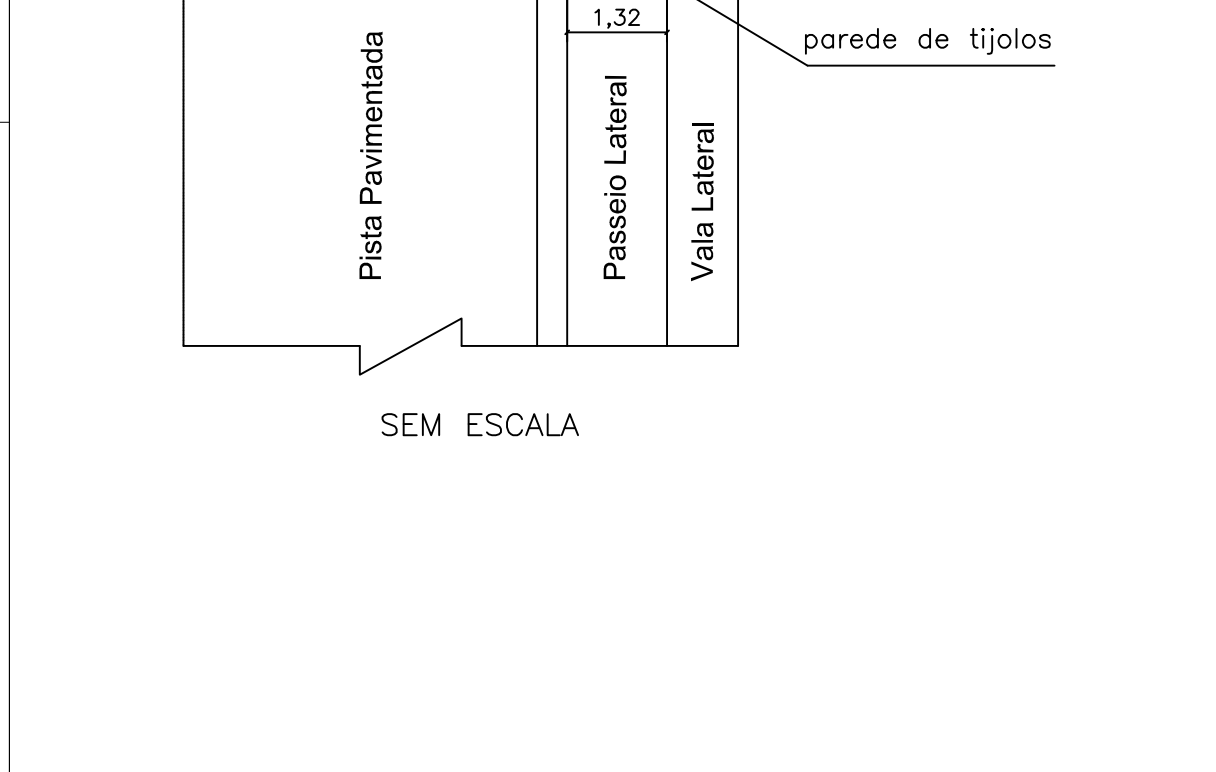

SEM ESCALA

OBS.: A rampa deve terminar no mesmo nível da via

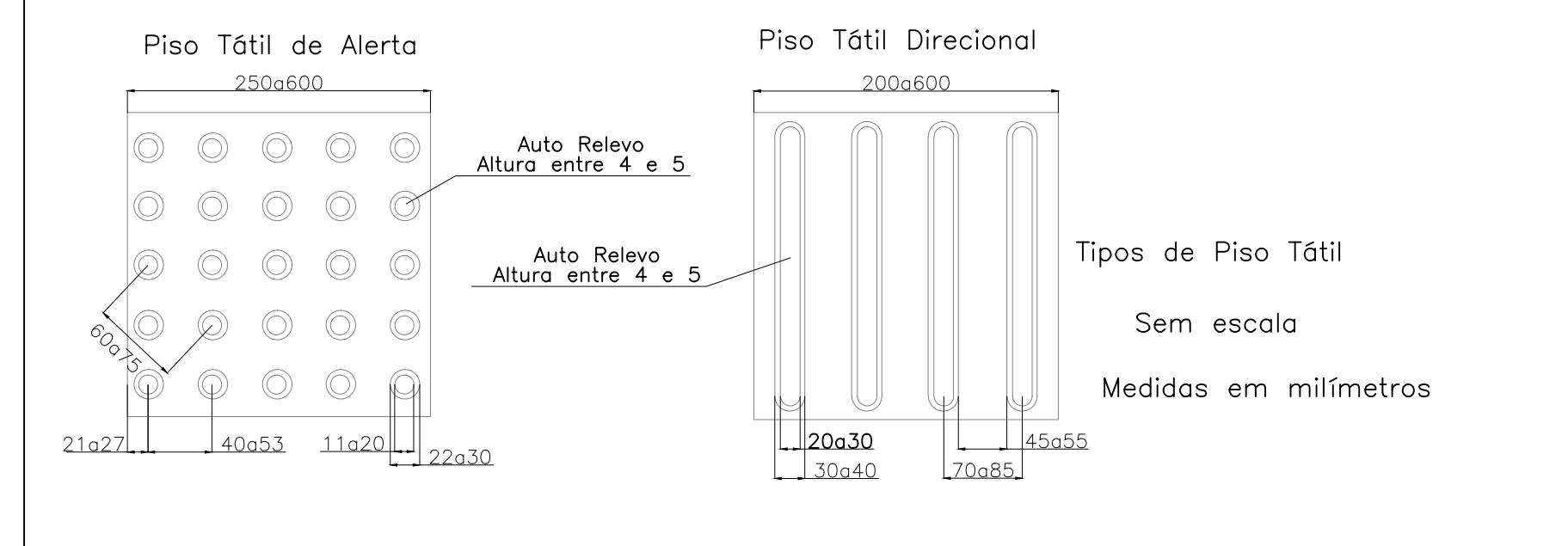
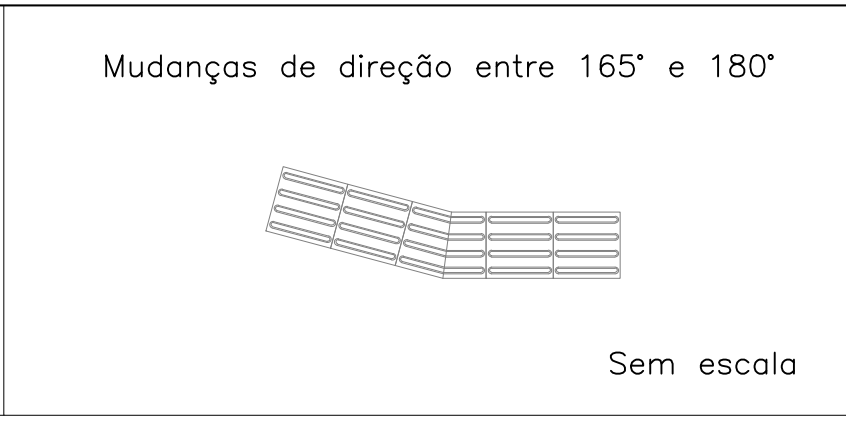
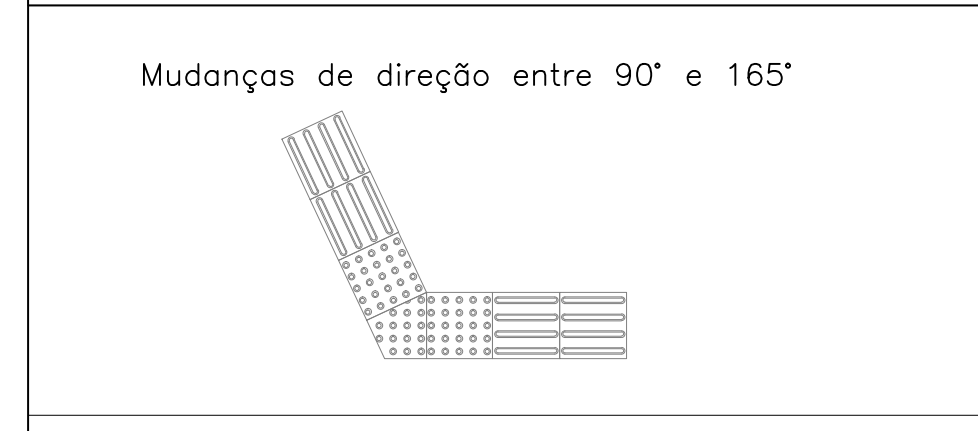
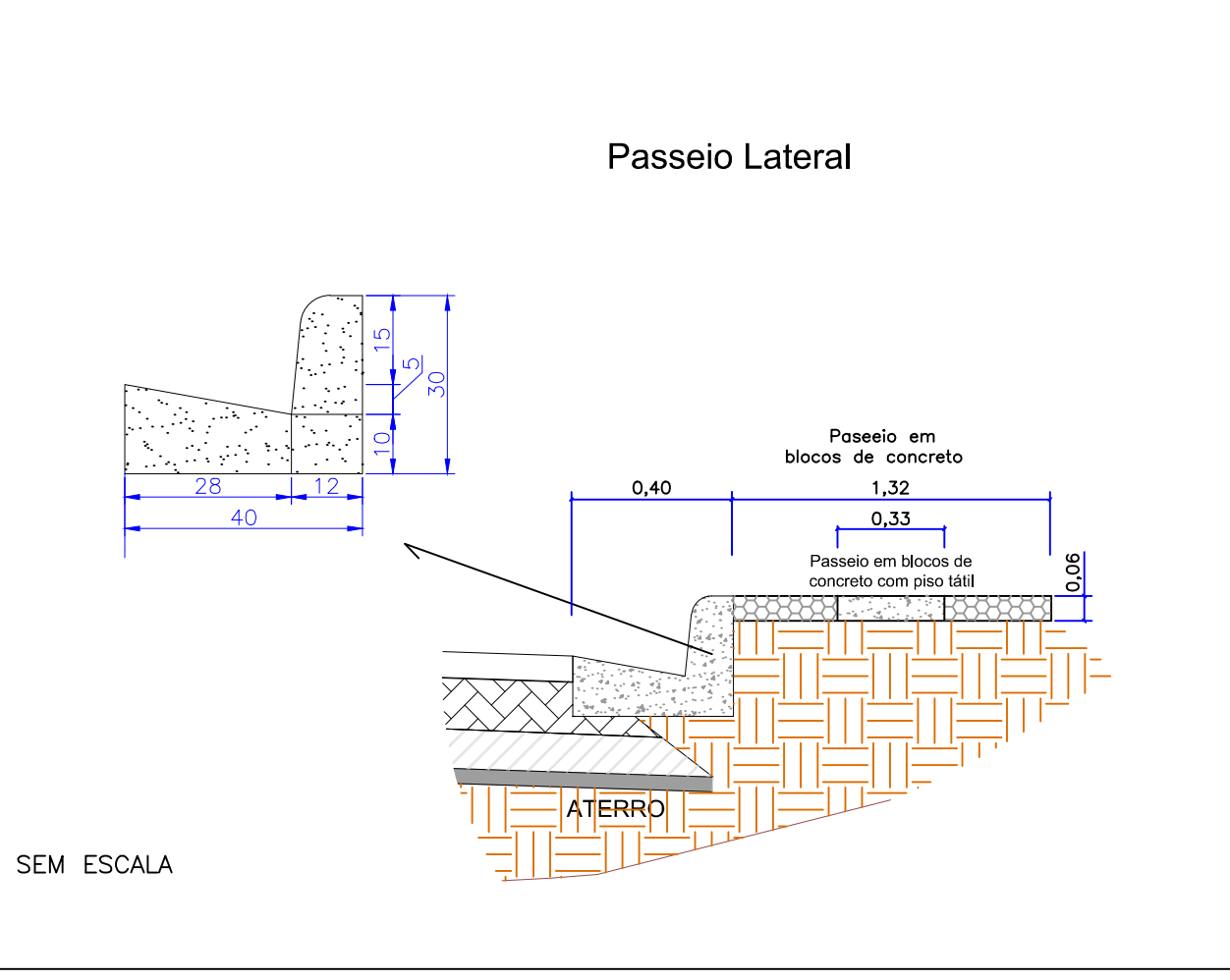
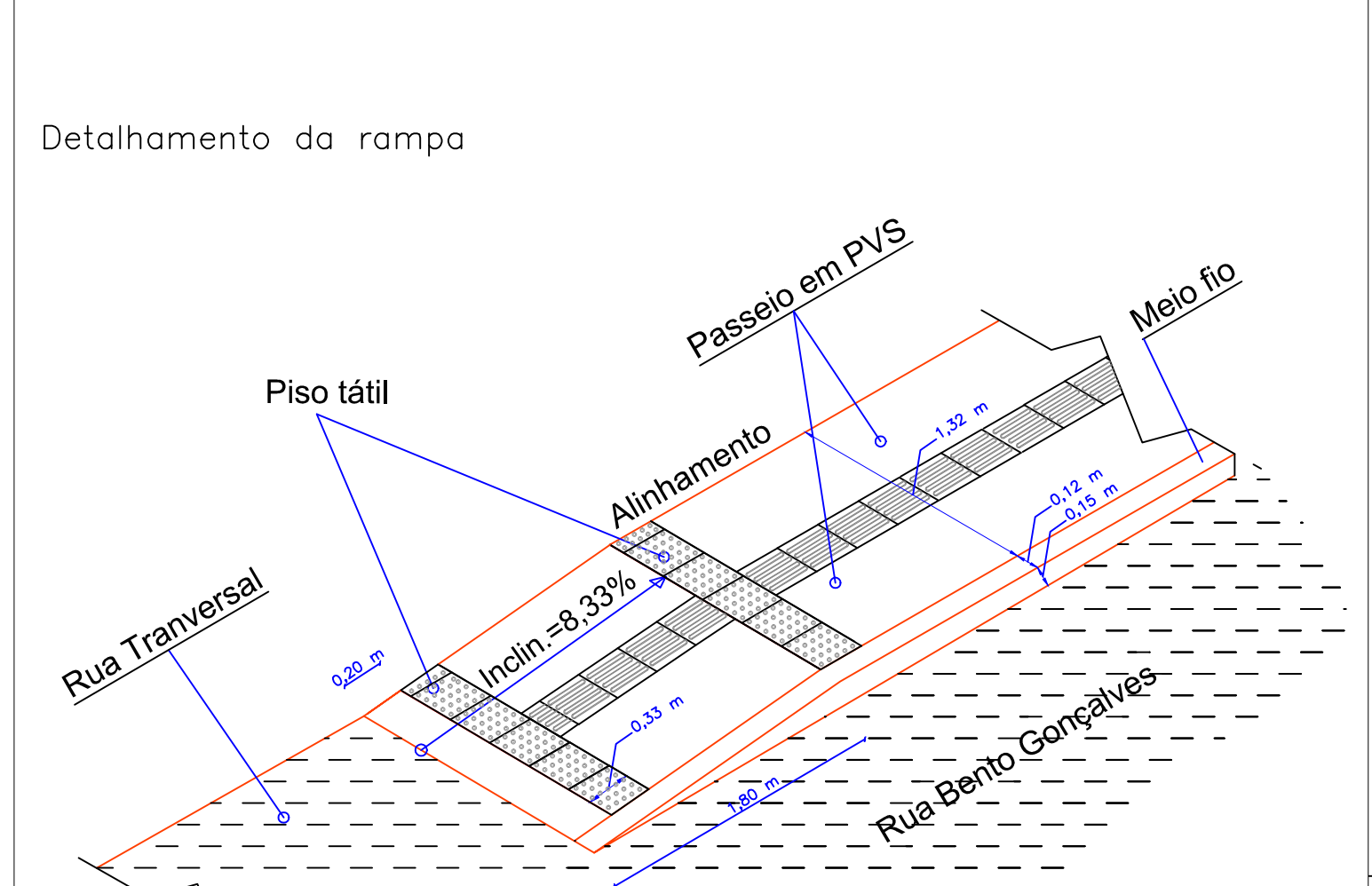
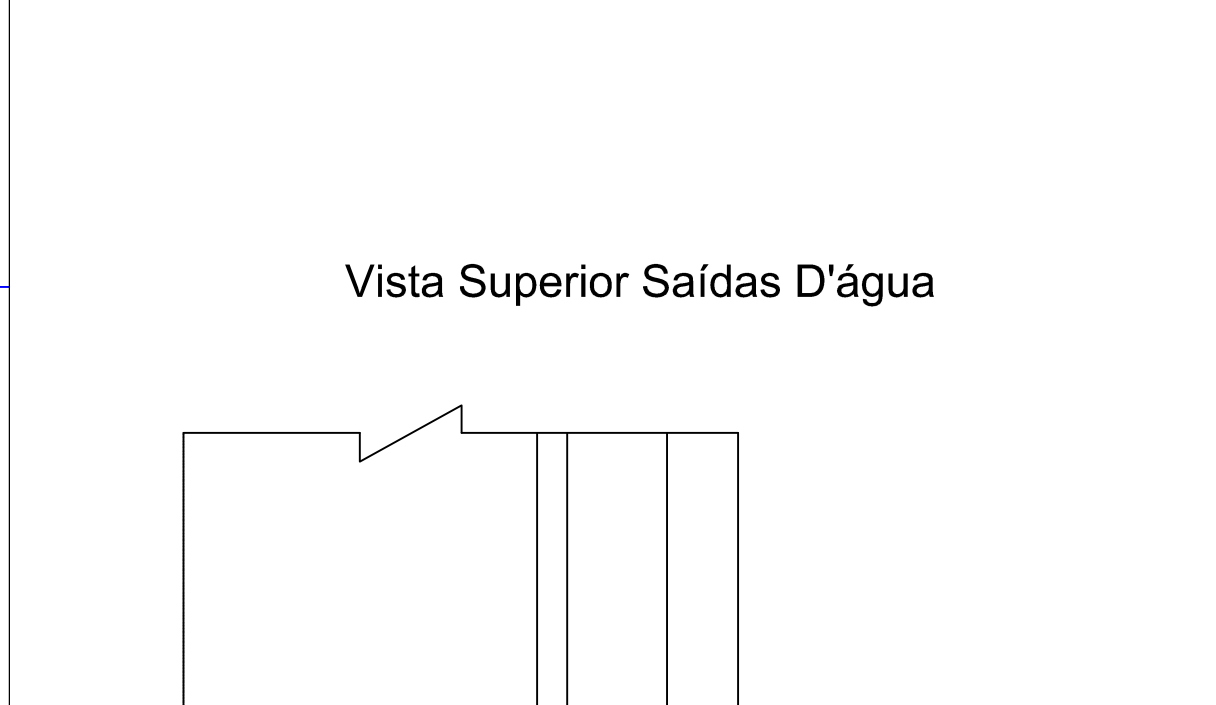
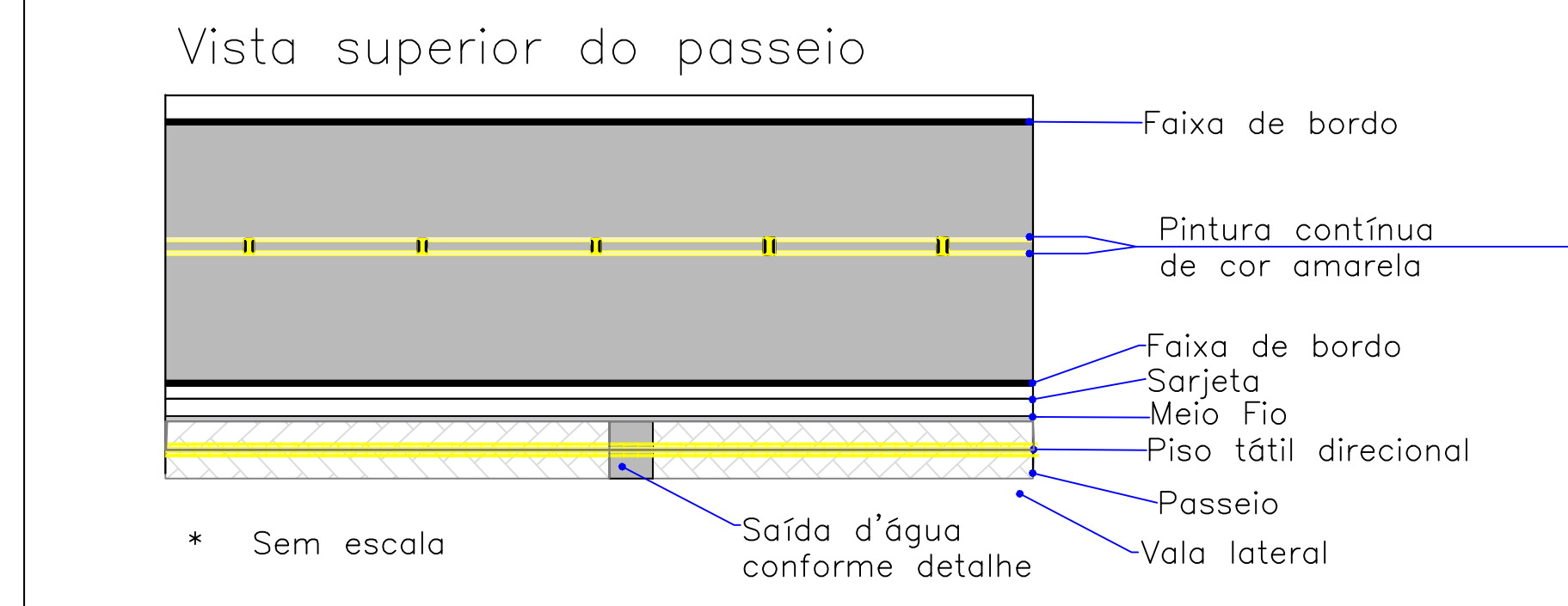
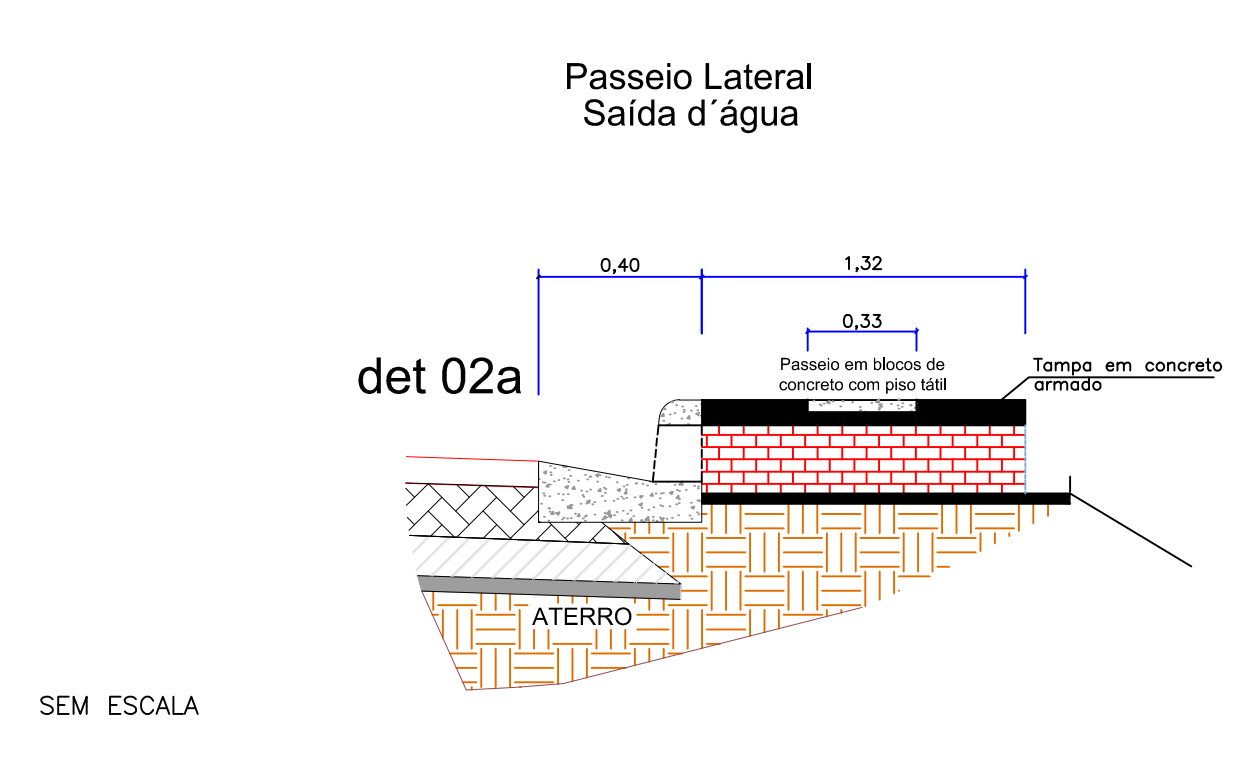

PAVIMENTAÇÃO PASSEIO PÚBLICO EM PAVs
RUA BENTO GONÇALVES TRECHO km 0+0,00 A 1+460,00

PROPRIETÁRIO

Prefeitura Municipal de Cotiporã CNPJ: 90.898.487/0001-64

RESPONSÁVEL TÉCNICO

ASSUNTO

PAVIMENTAÇÃO - PASSEIO PÚBLICO

01/01