

ESCALA 1/750

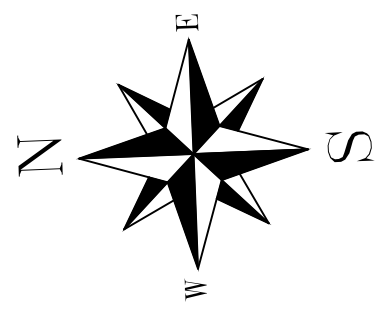

COTIPORÁ

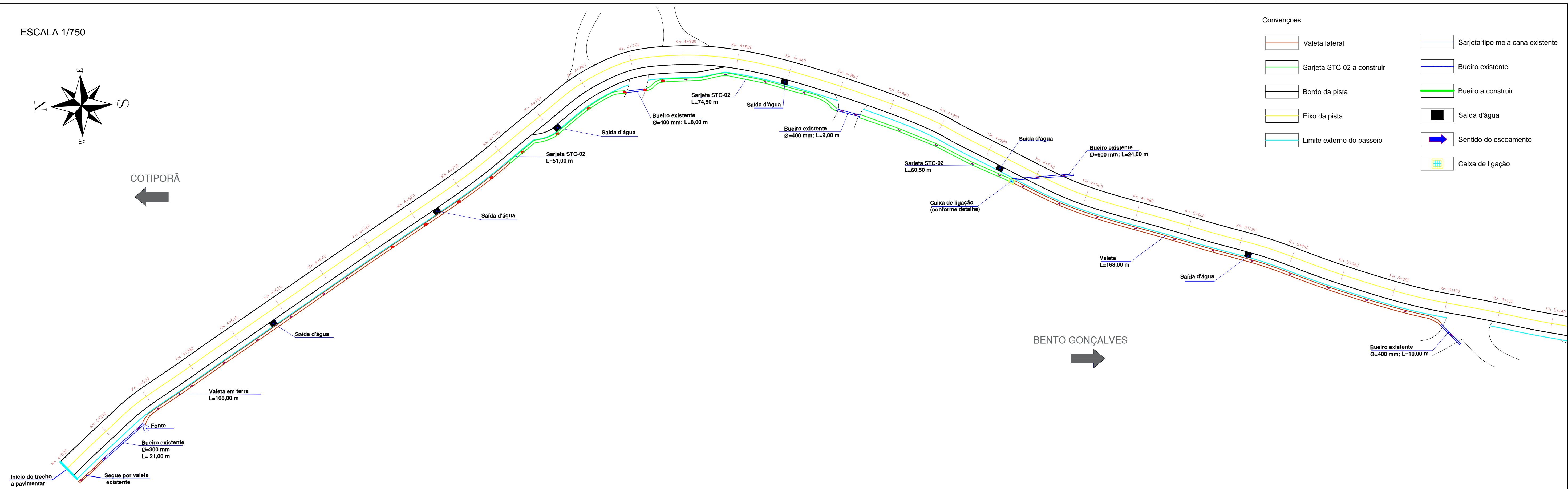

- Convenções
- Valeta lateral
 - Sarjeta STC-02 a construir
 - Bordo da pista
 - Eixo da pista
 - Limite externo do passeio
 - Sarjeta tipo meia cana existente
 - Bueiro existente
 - Bueiro a construir
 - Saída d'água
 - Sentido do escoamento
 - Caixa de ligação

ESCALA 1/750

COTIPORÁ

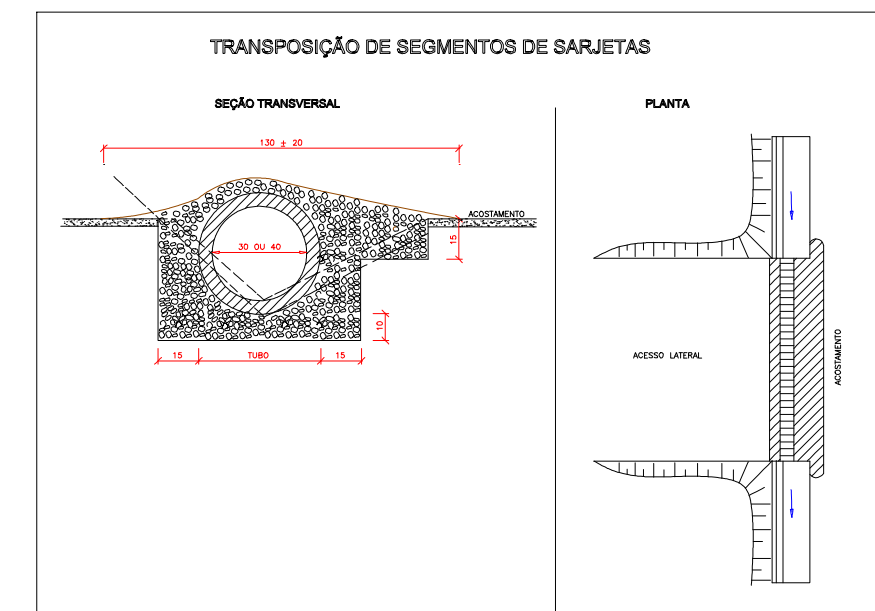
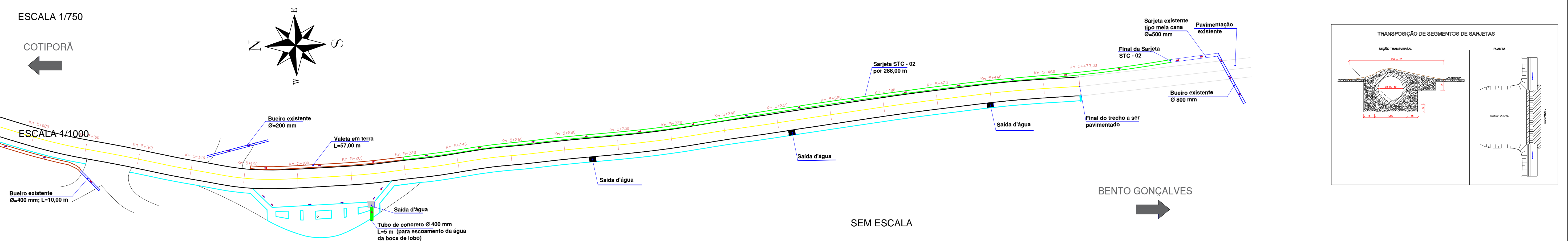
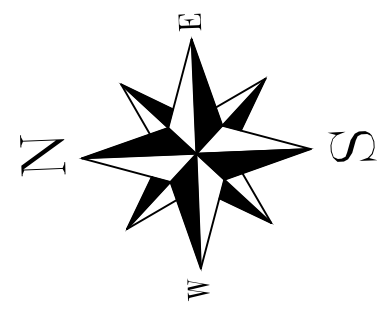

Detalhe Escavação de Bueiros

DETALHE DA ESCAVAÇÃO DE VALAS PARA COLOCAÇÃO DE BUEIROS

Ø (mm)	A (m)	B (m)	C (m)
1000	1,45	3,00	2,30
800	1,25	2,48	2,06
600	1,05	1,96	1,82
400	0,80	1,59	1,58
300	0,60	1,20	1,20

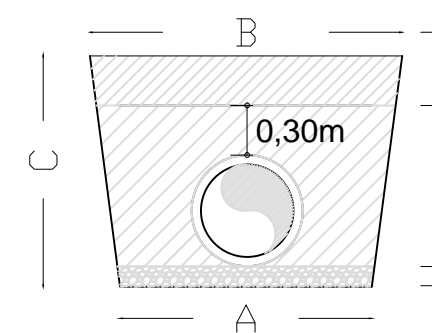

var. (mínimo 0,70m), mat. argiloso até a base do pavimento - 95% Proctor Normal
mat. argiloso selecionado, isento de corpos estranhos compactado em camadas de 0,20m
0,10m brita graduada

Detalhe Sarjeta STC02 (Padrão DNIT)

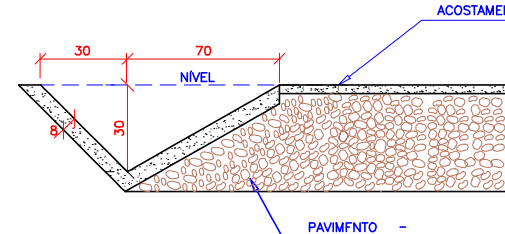

CONSUMOS MÉDIOS

CONCRETO (fa. > 15MPa)	0,28m³/m
GUIA DE MADEIRA (2,5cm x 8,0cm)	0,65m/m
ARGAMASSA ASFÁLTICA	0,14m³/m
ESCAVAÇÃO EM SOLO (EVENTUAL)	< 0,21m³/m
SOLO LOCAL (EVENTUAL)	< 0,20m³/m

Detalhe Caixa de Ligação

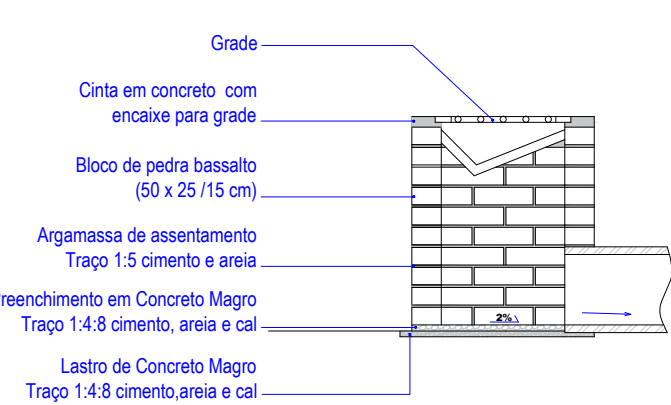
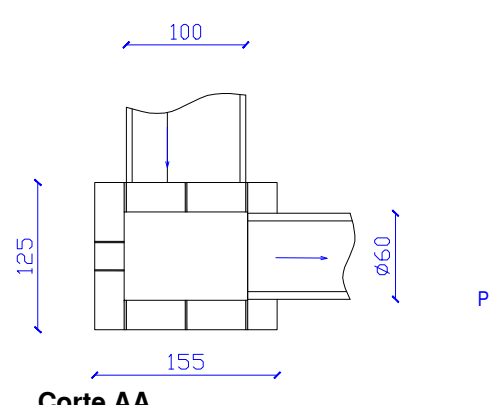
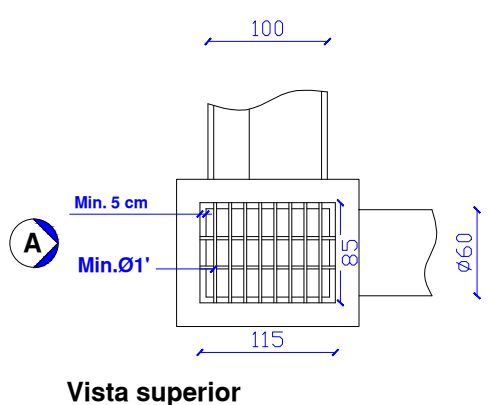

Passeio Lateral

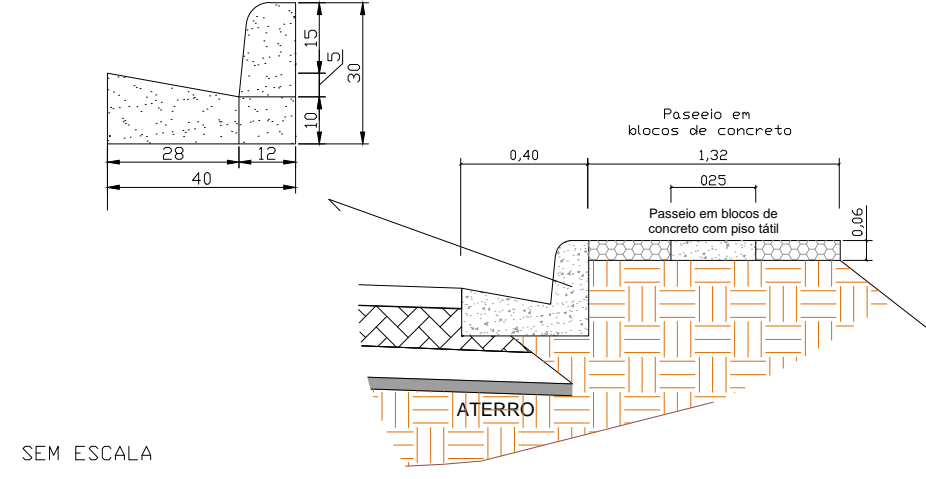

Passeio Lateral Saída d'água

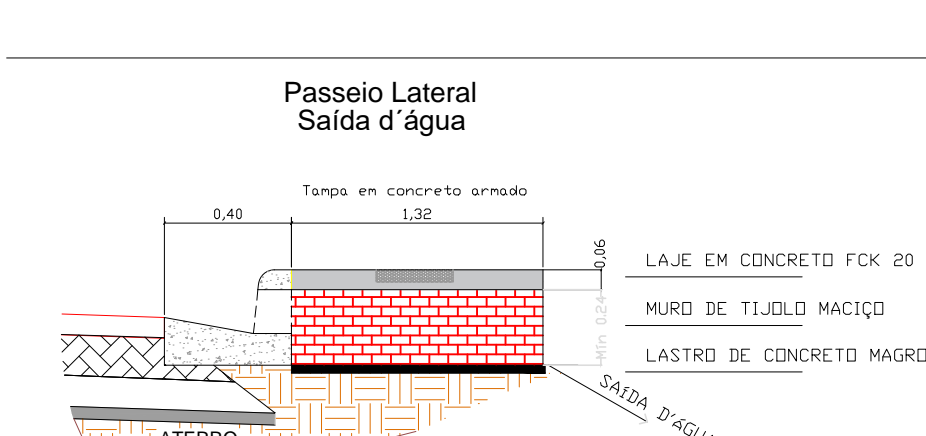

Vista Superior

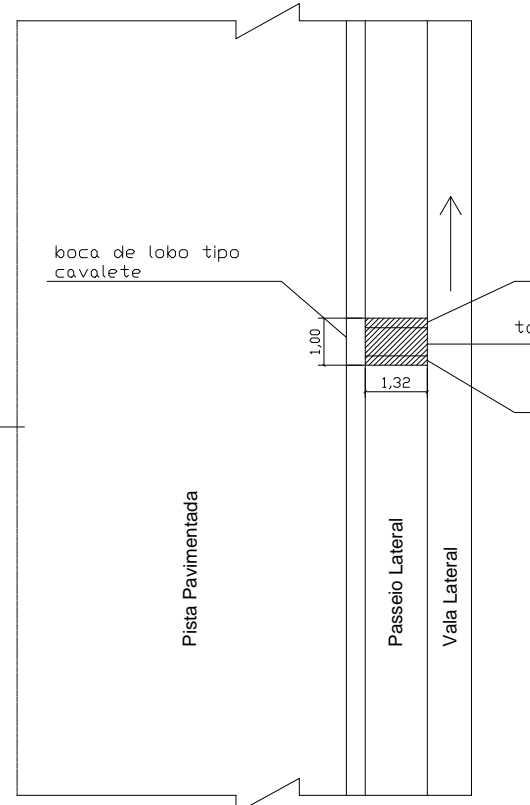

DETALHE DAS SAÍDAS DE ÁGUA

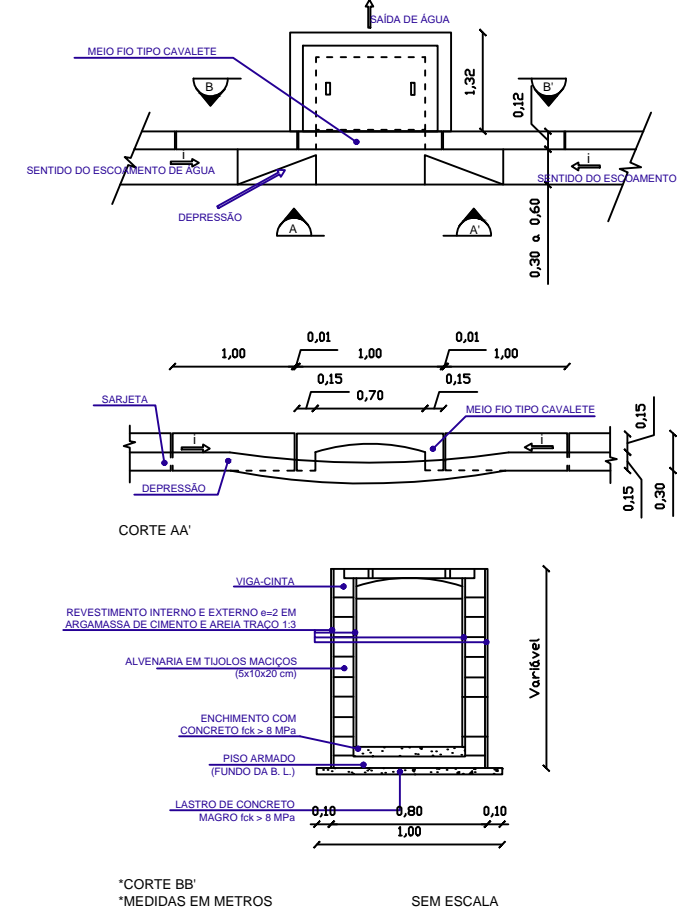

PAVIMENTAÇÃO ASFÁLTICA DA RUA BENTO GONÇALVES - Trecho km 4+520,00 a 5+473,00

PROPRIETÁRIO: Prefeitura Municipal de Cotiporá CNPJ: 90.898.487/0001-64

RESPONSÁVEL TÉCNICO: Engenheira Civil Kátia Benedetti | CREA RS201849

DATA: Agosto/2017

DESENHO: Kátia/Cristiano

ESCALA: Indicada

PRANCHA: 04